

T 12S., R 11E., M Will.

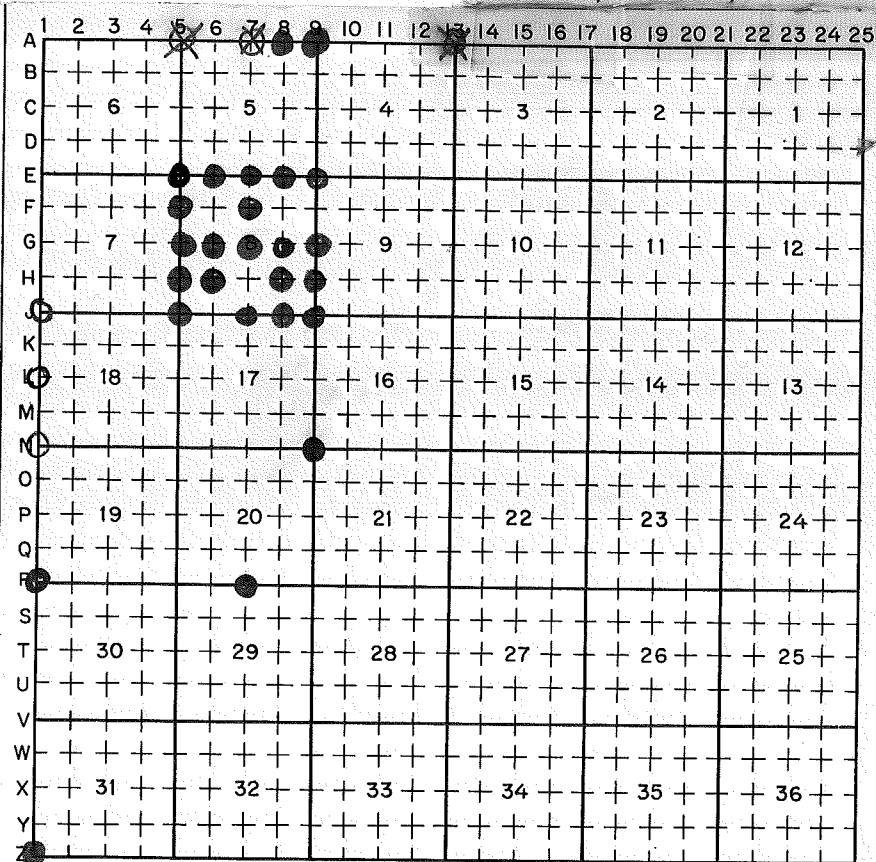

LEGEND

○ = Corner having information on form 5680-2 in this file.

FILING INSTRUCTION

File 5680-2 card record by letter and number coordinates behind the file guide for the township in which it falls.

File the 5680-2 card record by letter and then by number i.e., all A cards first, then B cards etc.

The first card behind the file guide (if data have been obtained and recorded) will be card A-1 for N.W. Township Corner, then card A-2 for 1/16 corner then card A-3 for 1/4 corner etc.

Index
File No. 0551 CORNER RECORD (SEARCH) Contract or
(Ref. FSM 7151.4) Survey No. _____ Cor. No. A-5
T 12 S. R. 11 E. R.D. SISTERS County JEFFERSON NW Cor. of
Merid. WILLAMETTE N.F. DESCHUTES State OREGON Section 5

SEE: Z-5 T. 11 S., R. 11 E. W.H.

EVIA. FOUND



Index
File No. 0751 CORNER RECORD (SEARCH) Contract or
(Ref. FSM 7151.4) Survey No. Cor. No. A-7
T 12 S. R. 11 E. R.D. SISTERS County JEFFERSON N/A Cor. of
Merid. WILLAMETTE N.F. DESCHUTES State OREGON Section 5

SEE: Z-07 T. 11 S., R. 11 E., W.M.

EVID. FOUND



Index
File No. 0851 CORNER RECORD (SEARCH) Contract or
(Ref. FSM 7151.4) Survey No. _____ Cor. No. A-08
T 12 S. R. 11 E. R.D. Sisters County Jedarran E/16 Cor. of
Merid. WILLAMETTE N.F. DESCHUTES State OREGON Section 32/35

SEE: 2-08 T. 11 S., R. 11 E., W.M.

Bcsp



CORNER RECORD (SEARCH)

(Ref. FSM 7151.4)

Index File No. 0951

T 12 S R. 11 E

Merid. Wmt

R.D. Sisters

County Jefferson

N.F. Deschutes

State OR

Tract or Survey No. _____

Cor. No. A-09

NW cor
sec. 4

CORNER DIAGRAM

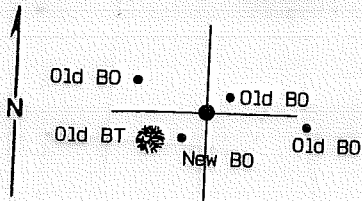

DESCRIBE CORNER MONUMENT FOUND

DE: Found 2 1/2" ACAP msg. 4" in stone collar from which:
1) 8" P. Pine in SW Record (1987) location, standing, dead & burnt.
All other BO's found in good condition.

PHOTO IDENTIFICATION DATA

Photo No. _____

Filed At. _____

Object Ident. _____

Ident. By _____

Signature

PLANE COORDINATE POSITION DATA

State _____ Zone _____

X _____

Y _____

Estab. By _____

Agency

DESCRIBE CORNER LOCATION RELATIVE TO NEAR-BY FEATURES, ALSO HOW TO REACH CORNER

Signature
Walt Miller

Title
PLS

Division
CS

Headquarters
SO

Date
07/05

CORNER RECORD (PERPETUATION)

MONUMENT: DESCRIBE NEW MONUMENT SET, OR WORK DONE TO PRESERVE EXISTING MONUMENT

2" AC on 1/2"x24" rebar, brs S41°W @ 14.1'; mkd "B01 PLS2111 2005"

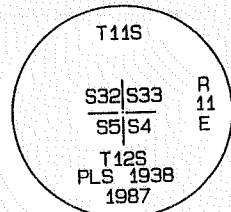

ACCESSORIES : DESCRIBE NEW BT's WITNESS OBJECTS ETC. ESTABLISHED, OR WORK DONE TO PRESERVE EXISTING EVIDENCE

Work Done By Walt Miller Title PLS Date 7/05 State Registration No. 2111
 or Agency _____
 Certified Cor. Record Prepared? Yes No Filed At: Jeff. Co. Date 2/19/06

REMARKS

1881, GLO (Judkins) established corner.
 1987, Fred Ast, per Record of Survey Recorded as Instrument No. 873735, set a 2 1/2"x30" ACAP
 rsg. 0.2' in a stone collar based on stump holes, from which:
 1) 8" P. Pine brs S61°W, 19.26' scribed T12S R11E S5 BT.
 2) 1 1/2" AC on 5/8"x30" IR brs N65°W, 25.45', rsg. 0.1' mkd "PLS1938 B0 S32 1987"
 3) 1 1/2" AC on 5/8"x30" IR brs N55°E, 6.88', rsg. 0.1' mkd "PLS1938 B0 S33 1987"
 4) 1 1/2" AC on 5/8"x30" IR brs S83 1/2°E, 34.51', rsg. 0.2' mkd "PLS1938 B0 S4 1987"

Index File No. 0951 T. 12 S R. 11 E M. Walt Miller Tract or Surv. No. _____ Cor. _____
 GPO: 1986 O - 439-095 12
13
A-09

Index
File No. 1351 CORNER RECORD (SEARCH) Contract or
(Ref. FSM 7151.4) Survey No. Cor. No. A-13
T 12 S. R. 11 E. R.D. SISTERS County JEFFERSON NW Cor. of
Merid. WILLAMETTE N.F. DESCHUTES State OREGON Section 3

SEE: 2-13 T. 11 S., R. 11 E. W.M.

EVID. FOUND



Index File No. 0555 CORNER RECORD (SEARCH) (Ref. FSM 7151.4) Tract or Survey No. _____ Cor. No. E-05
 T 12 S. R. 11 E. R.D. SISTERS County Jefferson
 Merid. WMT N.F. Deschutes State OR NW COR S.8

CORNER DIAGRAM

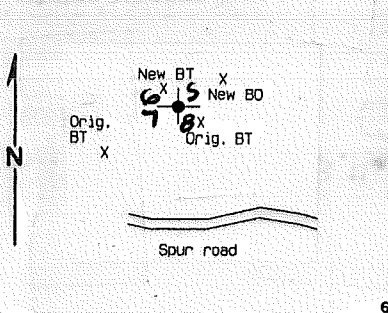

DESCRIBE CORNER MONUMENT FOUND

Found - Original Basalt stone 16x10x8 ins. faintly mkd. with 5 grooves on East edge. Faint chisel marks on South edge, lying in a mound of stones.

DESCRIBE BEARING TREES OR OTHER OFFICIAL ACCESSORIES FOUND

A Juniper, 20" dia., S58°E., 29 lks. with face and scribing visible.
 Remains of a burnt Juniper in NE BT location. No other evidence.
 A Juniper, 22" dia., S68°W., 144 lks. with overgrown face.
 A burnt Pine snag, N64°W., 52 lks., with face and scribing visible.
 Distances measured to chaining notch.

PHOTO IDENTIFICATION DATA

Photo No. _____
 Filed At _____
 Object Ident. _____
 Ident. By _____
 Signature _____

DESCRIBE CORNER LOCATION RELATIVE TO NEAR-BY FEATURES, ALSO HOW TO REACH CORNER

PLANE COORDINATE POSITION DATA

State _____ Zone _____
 X _____
 Y _____
 Estab. By _____
 Agency _____

Signature William B. Ham Title PLS Division CS Headquarters SO Date 07/01 FS-7100-52 (3/68)

CORNER RECORD (PERPETUATION)

MONUMENT: DESCRIBE NEW MONUMENT SET, OR WORK DONE TO PRESERVE EXISTING MONUMENT

Set a 2 1/2" dia. x 30" long steel pipe surmounted by a 2 1/2" dia. brass cap rising 6" in a mound of stone. A penny at base of pipe. Orig. stone buried on South side. A steel fence post 3.5 North. A PK nail in a boulder, 7'x3'x3.5' high, N.47° E., 35.0 ft., boulder mkd. X BO.
 A Juniper, 20" dia., S.58° E., 49.3 ft., Original BT, not re-marked.
 A Juniper, 22" dia., S.68° W., 95.6 ft., Original BT, not re-marked.
 A Juniper 7" dia., N.63° W., 32.9 ft., mkd. X BT.

Trees measured to side center at the root crown. A 1" dia. brass washer mkd. LS 2396 nailed to the blaze between the B & T of the scribing.

ORE SPC, NAD 27 North Zone, mapping grade GPS.
 324525 N.,
 1754914 E.

A location poster on old spur road 10 chains South of corner.

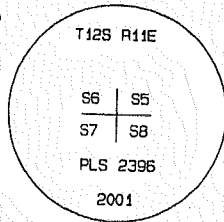

DONE TO PRESERVE EXISTING EVIDENCE

Work Done By William B. Han Title PLS Date 07/01 State Registration No. 2396
 or Agency _____

Certified Cor. Record Prepared? Yes No Filed At: Jett Co. Date 7/19/01

REMARKS

GLO Survey of 1883 by Samuel Lackland, under Contract # 476.
 Record - Set Sand stone 16x10x10 ins. 10 ins. in ground for cor. to Secs. 5, 6, 7 and 8,
 marked with 5 notches on S. and E. edges, from which,
 A Juniper 10 in. diam. bears S. 57° E. 30 lks. dist. marked T12S.R11E. S8 B.T.
 A Juniper 10 in. diam. bears N. 59° E. 135 lks. dist. marked T12S.R11E. S5 B.T.
 A Juniper 8 in. diam. bears S. 65° W. 142 lks. dist. marked T12S.R11E. S 7 B.T.
 A y. Pine 12 in. diam. bears N. 66° W. 50 lks. dist. marked T12S.R11E. S 6 B.T.

Index File No. 0555 T. 12 R. 11 M. _____ Tract or Surv. No. _____ Cor. E-05

GPO: 1986 O - 439-095

Index
File No. E-6 0655

CORNER RECORD (SEARCH)
(Ref. FSM 7151.4)

Tract or
Survey No. 1-1

Cor.
No. E-06

T 12 S. R. 11 E.

R.D. Sisters County Jefferson

W/16 S/8

Merid. Willamette

N.F. Deschutes State Oregon

CORNER DIAGRAM

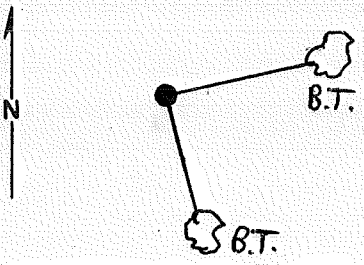

DESCRIBE CORNER MONUMENT FOUND

None found, not previously monumented

DESCRIBE BEARING TREES OR OTHER OFFICIAL ACCESSORIES FOUND

None found, not previously monumented

PHOTO IDENTIFICATION DATA

Photo No. _____
Filed At _____
Object Ident. _____
Ident. By _____
Signature

DESCRIBE CORNER LOCATION RELATIVE TO NEAR-BY FEATURES, ALSO HOW TO REACH CORNER

Go west along the North line of Section 8 approximately 2800'± from where Forest Road #900 crosses the section line.

PLANE COORDINATE POSITION DATA

State _____ Zone _____
X _____
Y _____
Estab. By _____
Agency

David P. Worthington

Title LS1026

Division

Headquarters

Date 11/28/2001

FS-7100-52 (3/68)

CORNER RECORD (PERPETUATION)

MONUMENT: DESCRIBE NEW MONUMENT SET, OR WORK DONE TO PRESERVE EXISTING MONUMENT

Set 2-1/2" O.D. X 30" long galvanized iron pipe with 2-1/2" O.D. Brass cap.
 Pipe is 15" in the ground.
 Raised 3 foot diameter stone mound to cap.
 Set a steel fence post 3 feet West of cap.

T12S R11E
 W 1/16 55
 LS 1026
 2001

CAP
 MARKED:

ACCESSORIES : DESCRIBE NEW BT'S WITNESS OBJECTS ETC. ESTABLISHED, OR WORK DONE TO PRESERVE EXISTING EVIDENCE

5" Ponderosa pine, N76°E, 30[±] feet, scribed "W 1/16 55 BT";
 14" Ponderosa Pine, S07-1/2°E, 19[±] feet, scribed "XBT".
 Painted faces red and a red band 6 feet above ground. Nailed brass
 washer stamped "LS1026" to faces. Attached 54-3 "Bearing Tree" signs.
 Attached flasher sign to back of trees.

Work Done By David B. Armstrong Title Land Surveyor Date 10/24/01 State Registration No. LS1026
 or Agency

Certified Cor. Record Prepared? Yes No Filed At: _____ Date _____

REMARKS

CONTRACT NO. 50-04GG-1-039

Index File No. E-6 T. 12S. R. 11 E M. W.M. Tract or Surv. No. 1-1 Cor. _____

Index
File No. 0755

CORNER RECORD (SEARCH)

(Ref. FSM 7151.4)

Tract or
Survey No. _____Cor.
No. E-07T 12 S. R. 11 E.R.D. SISTERSCounty JeffersonMerid. WmtN.F. DeschutesState ORN/4 S. 8

CORNER DIAGRAM

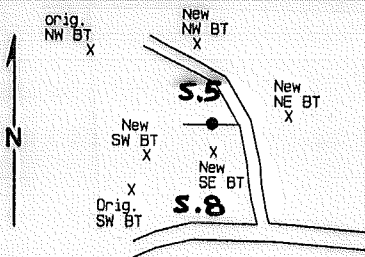

DESCRIBE CORNER MONUMENT FOUND

Found Original stone 15"x10"x8" clearly marked 1/4 on North face, lying on the ground on edge of road. A rebar by G. Cook L.S. 540 in 1978 per CS 128810 filed in 1995 in County Surveyors Office is 6 ft. north of stone. I accept the rebar as the corner position since it already has a survey tied to it and because the stone may have been moved during road construction activities.

DESCRIBE BEARING TREES OR OTHER OFFICIAL ACCESSORIES FOUND

A Ponderosa Pine windfall, 40" dia. S.55°W., 32 lks. with face and scribing visible.
A Ponderosa Pine windfall, rotted, N.79°E., 123 lks., fallen on its face.
Note: Distances measured to stump holes.

A location poster on old spur road, 15 ft. Northeast.

PHOTO IDENTIFICATION DATA

Photo No. _____

Filed At _____

Object Ident. _____

Ident. By _____

Signature

PLANE COORDINATE POSITION DATA

State _____ Zone _____

X _____

Y _____

Estab. By _____

*Agency*Signature
Williams B. HamTitle
PLSDivision
CSHeadquarters
SODate
07/01

FS-7100-52 (3/68)

CORNER RECORD (PERPETUATION)

MONUMENT: DESCRIBE NEW MONUMENT SET, OR WORK DONE TO PRESERVE EXISTING MONUMENT

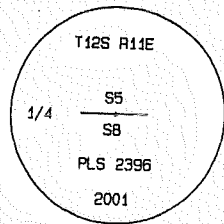

Set a 2 1/2" dia. x 30" long steel pipe surmounted by a 2 1/2" dia. brass cap rising 8" in a mound of stone. A penny at base of pipe. Orig. stone buried on North side. A steel fence post 3 ft. North.

- A Ponderosa Pine, 15" dia., N.89° E., 45.0 ft., mkd. 1/4 S5 BT.
- A Ponderosa Pine, 10" dia., S.05° E., 11.9 ft., mkd. 1/4 SB BT.
- A Juniper, 8" dia., S.62° W., 21.1 ft., mkd. X BT.
- A Ponderosa Pine, 7" dia., N.10° W., 52.9 ft., mkd. X BT.

***RESERVE EXISTING EVIDENCE**

Note: Distances measured to side center of the root crown. A 1" dia. brass washer mkd. LS 2396 nailed to the blaze between the B & T of the scribing.

ORE SPC, NAD 27, North Zone, Mapping Grade GPS,
324510 N.
1754550 E.

Work Done By Bill Ham Title PLS Date 7/01 State Registration No. 2396
or Agency

Certified Cor. Record Prepared? Yes No Filed At: Jeff. Co. Date 7/19/01

REMARKS

GLO Survey of 1883 by Samuel Lackland under Contract #476.
Record - @ 39.85 chs. Set Basalt stone 16x10x8 ins. 10 ins. in ground for 1/4 Sec. cor,
marked 1/4 on N. face, from which
A Y. Pine 40 in. diam. bears S. 45° W. 32 lks. dist. marked 1/4 S B.T.
A Y. Pine 26 in. diam. bears N. 79° W. 121 lks. dist. marked 1/4 S B.T.

G. Cook, LS 540, MF128810. Please see below.

Index File No. 0755 T. R. M. Tract or Surv. No. Cor. E-07

Index File No. 177 0855

CORNER RECORD (SEARCH)
(Ref. FSM 7151.4)

Tract or Survey No. 1-1

Cor. No. E-08

T 12 S. R. 11 E.

R.D. Sisters County Jefferson

Merid. W.M.

N.F. Deschutes State Oregon E/16 S/8

CORNER DIAGRAM

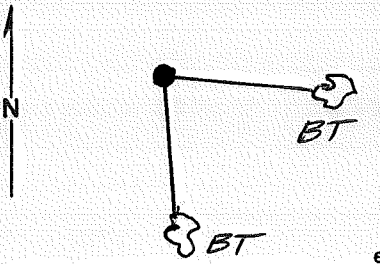

DESCRIBE CORNER MONUMENT FOUND

None found, not previously monumented

2

DESCRIBE BEARING TREES OR OTHER OFFICIAL ACCESSORIES FOUND

None found, not previously monumented

6

PHOTO IDENTIFICATION DATA

Photo No. _____
Filed At _____
Object Ident. _____
Ident. By _____
Signature

7

DESCRIBE CORNER LOCATION RELATIVE TO NEAR-BY FEATURES, ALSO HOW TO REACH CORNER

Go North along Forest Road #900 approximately 1/4 of a mile from the intersection of Forest Road #960. Corner lies 220'± West of Road.

3

PLANE COORDINATE POSITION DATA

State _____ Zone _____
X _____
Y _____
Estab. By _____
Agency

8

David B. Armstrong - Signature

Division LS1026

Headquarters

Date 11/28/2001

FS-7100-52 (3/68)

4

5

CORNER RECORD (PERPETUATION)

MONUMENT: DESCRIBE NEW MONUMENT SET, OR WORK DONE TO PRESERVE EXISTING MONUMENT

Set 2-1/2" O.D. X 30" long galvanized iron pipe with 2-1/2" brass cap.
 Pipe is 17" in the ground. T12S R11E

Raised 2-1/2 foot diameter stone mound to cap. E 1/16 S 5/8

Set a steel fence post 5 feet south of cap. CAP L51026
 MARKED: 2001

ACCESSORIES: DESCRIBE NEW BT'S WITNESS OBJECTS ETC. ESTABLISHED, OR WORK DONE TO PRESERVE EXISTING EVIDENCE

7" Ponderosa Pine, S 88° E, 47 ± feet, scribed "XBT";

8" Ponderosa Pine, S 02-1/2° E, 66.6 feet, scribed "E 1/16 S 5/8 BT".

Painted faces red and a red band 6 feet above ground. Nailed brass washer stamped "L51026" to faces. Attached 54-3" Bearing Tree" signs.

Attached flasher sign to back of trees.

Work Done By David B. Armstrong Title Land Surveyor Date 11/24/01 State Registration No. L51026
 or Agency

Certified Cor. Record Prepared? Yes No Filed At: _____ Date _____

REMARKS

CONTRACT NO. 50-04GG-1-039

Index File No. E-8 T. 12S. R. 11E. M. W.M. Tract or Surv. No. [-] Cor. _____

Index File No. 0955

CORNER RECORD (SEARCH)
(Ref. FSM 7.151.4)

Tract or Survey No. _____
Cor. No. E-09

T 12 S. R. 11 E.

R.D. SISTERS County Jefferson

Merid. W.M.T.

N.F. Deschutes State OR

NW Cor. S.9

CORNER DIAGRAM

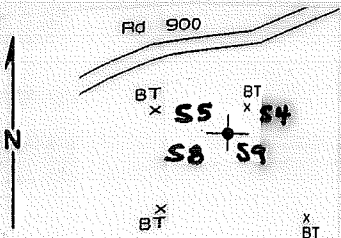

DESCRIBE CORNER MONUMENT FOUND

Found - Original stone 16x13x6 ins. mkd. with 5 notches on South and 4 grooves on East faces, lying in a mound of stones, approximately 6 ft. West of a old fence corner.

DESCRIBE BEARING TREES OR OTHER OFFICIAL ACCESSORIES FOUND 2

Stump holes in the NE and NW BT positions.
A depression in the ground (a possible stump hole) in the SE BT position.
An old road obliterated the SW BT.
An old location poster on the 900 road approx. 9 chs. North of corner.

PHOTO IDENTIFICATION DATA 6

Photo No. _____
Filed At. _____
Object Ident. _____
Ident. By _____
Signature _____ 7

DESCRIBE CORNER LOCATION RELATIVE TO NEAR-BY FEATURES, ALSO HOW TO REACH CORNER 3

PLANE COORDINATE POSITION DATA

State _____ Zone _____
X _____
Y _____
Estab. By _____
Agency _____ 8

Signature William B. Ham Title PLS Division CS Headquarters SO Date 7/01 4
FS-7100-52 (3/68) 5

CORNER RECORD (PERPETUATION)

MONUMENT: DESCRIBE NEW MONUMENT SET, OR WORK DONE TO PRESERVE EXISTING MONUMENT

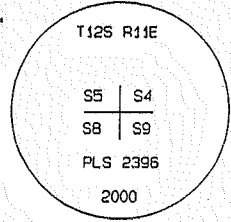

Set a 2 1/2" dia. x 30" long steel pipe surmounted by a 2 1/2" dia. brass cap rising 6" in a mound of stone. A penny at base of pipe. Orig. stone buried along N. side. A steel fence post 3 ft. North.

- A Juniper 8" dia., N.60° E., 6.1 ft., mkd. X BT.
- A Ponderosa Pine, 14" dia., S.64° E., 75.6 ft., mkd. T12SR11E S9 BT.
- A Juniper 7" dia., S.36° W., 65.5 ft., mkd. T12SR11E S8 BT.
- A Juniper 6" dia., N.69° W., 16.9 ft., mkd. T12SR11E S5 BT.

Trees measured to side center at the root crown. A 1" dia. brass washer mkd. LS 2396 nailed to the blaze between the B & T of the scribing.

Differentially corrected, Mapping Grade GPS.
 ORE SFC, NAD 27 North Zone
 324491 N.
 1757150 E.

EXISTING EVIDENCE

9

10

Work Done By Bill Ham Title PLS Date 7/01 State Registration No. 2396
 or Agency _____

Certified Cor. Record Prepared? Yes No Filed At: Jeff. Co. Date 07/19/01

11

REMARKS

GLD Survey of 1883 by Samuel Lacklund, under Contract # 476.
 Record - Set Sand stone 16x14x7 ins. 14 ins. in ground for cor. to Secs. 4, 5, 8 and 9.
 marked with 5 notches on S. and 4 notches on E. edges, from which

- A y. Pine 20 in. diam. bears N. 72° E. 38 lks. dist. marked T12S R11E S4 B.T.
- A y. Pine 36 in. diam. bears N. 30° W. 160 lks. dist. marked T12S R11E S5 B.T.
- A y. Pine 20 in. diam. bears S. 54° W. 64 lks. dist. marked T12S R11E S 8 B.T.
- A y. Pine 24 in. diam. bears S. 13° E. 89 lks. dist. marked T12SR11E S 9 B.T.

12

Index File No. 0955 T. _____ R. _____ M. _____ Tract or Surv. No. _____ Cor. E-09

13

Index
File No. F-5 0556CORNER RECORD (SEARCH)
(Ref. FSM 7151.4)Tract or
Survey No. 1-1Cor.
No. F-05T 12S. R. 11E.R.D. Sisters County JeffersonN/16 7/8Merid. W.M.N.F. Deschutes State Oregon

CORNER DIAGRAM

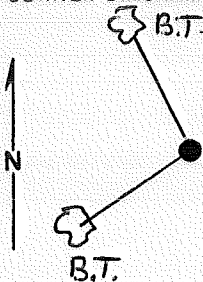

DESCRIBE CORNER MONUMENT FOUND

None Found, Not previously monumented.

DESCRIBE BEARING TREES OR OTHER OFFICIAL ACCESSORIES FOUND

None Found, Not previously monumented.

PHOTO IDENTIFICATION DATA

Photo No. _____

Filed At. _____

Object Ident. _____

Ident. By _____

Signature _____

PLANE COORDINATE POSITION DATA

State _____ Zone _____

X _____

Y _____

Estab. By _____

Agency _____

DESCRIBE CORNER LOCATION RELATIVE TO NEAR-BY FEATURES, ALSO HOW TO REACH CORNER

Go westerly along Forest Road #900 approximately 3/4 of a mile from intersection with Forest Road #960. Corner lies 1650'± North of Road.

Signature David B. Armstrong Title _____ Division L51026

Headquarters _____

Date

11/28/2001

FS-7100-52 (3/68)

CORNER RECORD (PERPETUATION)

MONUMENT: DESCRIBE NEW MONUMENT SET, OR WORK DONE TO PRESERVE EXISTING MONUMENT

Set 2-1/2" O.D. x 30" long galvanized iron pipe with 2-1/2" O.D. Brass cap.
 Pipe is 15" in the ground
 Raised 3 foot diameter stone mound to cap.
 Set a steel fence post 3 feet North of cap.

T125 R11E
 N 1/16
 S 71/58
 LS1026
 2001

CAP
 MARKED:

ACCESSORIES: DESCRIBE NEW BT'S WITNESS OBJECTS ETC. ESTABLISHED, OR WORK DONE TO PRESERVE EXISTING EVIDENCE

14" Ponderosa Pine, N37°W, 31.4 ft., scribed "XBT";
 10" Juniper, S74-1/2°W, 56.8 ft., scribed "N 1/16 S 7 BT".
 Painted faces red and a red band 6 feet above ground. Nailed brass washer stamped "LS1026" to faces. Attached 54-3 "Bearing Tree" signs.
 Attached flasher sign to back of trees.

Work Done By David B. Armstrong Title Land Surveyor Date 10/24/01 State Registration No. LS 1026
 or Agency

Certified Cor. Record Prepared? Yes No Filed At: _____ Date _____

REMARKS

CONTRACT NO. 50-04GG-1-039

Index File No. F-5 T. 125 R. 11E M. W.M. Tract or Surv. No. 1-1 Cor. _____

USDA-FOREST SERVICE

Index File No. F-7 0756

CORNER RECORD (SEARCH)
(Ref. FSM 7151.4)

Tract or Survey No. 1-1

Cor. No. F-07

T 12S R. 11E

R.D. Sisters County Jefferson

Merid. W.M.

N.F. Deschutes State Oregon CN 416 S.B

CORNER DIAGRAM

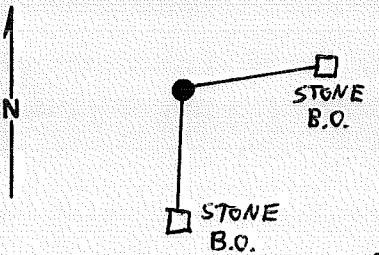

DESCRIBE CORNER MONUMENT FOUND

None found, Not previously monumented.

DESCRIBE BEARING TREES OR OTHER OFFICIAL ACCESSORIES FOUND

None found, not previously monumented.

PHOTO IDENTIFICATION DATA

Photo No. _____
Filed At _____
Object Ident. _____
Ident. By _____
Signature

DESCRIBE CORNER LOCATION RELATIVE TO NEAR-BY FEATURES, ALSO HOW TO REACH CORNER

Corner lies 200' North and 1320' West of the intersection of Forest Roads #900 and #960.

PLANE COORDINATE POSITION DATA

State _____ Zone _____
X _____
Y _____
Estab. By _____
Agency

David D. Armstrong Signature Title

Division LS 1026

Headquarters

Date 11/28/2001

FS-7100-52 (3/68)

CORNER RECORD (PERPETUATION)

MONUMENT: DESCRIBE NEW MONUMENT SET, OR WORK DONE TO PRESERVE EXISTING MONUMENT

Set 2-1/2" O.D. X 30" long galvanized iron pipe with 3-1/4" O.D. Brass cap.
 Pipe is 18" in the ground.
 Raised 3 foot diameter stone mound to cap.
 Set a steel post 3 feet North of cap.

T12SR11E
 Cap marked: N 116 1/2 S 8
 C
 L51026
 2001

ACCESSORIES : DESCRIBE NEW BT'S WITNESS OBJECTS ETC. ESTABLISHED, OR WORK DONE TO PRESERVE EXISTING EVIDENCE

5' x 5' x 3' Basalt stone, N 82° E, 7.31 ft., marked "B0 X"
 5' x 4' x 2' Basalt stone, S 00-1/2° E, 21.77 ft., marked "B01 X"
 Distances and bearings are measured to the center of the "X"

10

Work Done By David B. Armstrong Title Land Surveyor Date 10/23/01 State Registration No. LS1026
 or Agency

Certified Cor. Record Prepared? Yes No Filed At: _____ Date _____

11

REMARKS

CONTRACT NO. SO-0466-1-039

Index File No. F-7 T. 125 R. 11 E. M. W.M. Tract or Surv. No. 1-1 Cor. _____

12

13

Index
 File No. 0557
 T 12 S. R. 11 E.
 Merid. WMT

CORNER RECORD (SEARCH)
 (Ref. FSM 7151.4)

R.D. SISTERS County Jefferson
 N.F. Deschutes State OR

Tract or
 Survey No. _____
 Cor. No. G-05
w/4 S.8

CORNER DIAGRAM

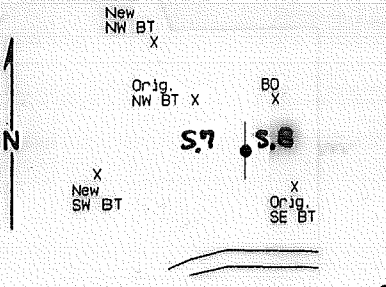

DESCRIBE CORNER MONUMENT FOUND

Found Original stone 16"x16"x8" clearly marked 1/4 on West face, in a mound of stone, with open top 4.

DESCRIBE BEARING TREES OR OTHER OFFICIAL ACCESSORIES FOUND

A Ponderosa Pine snag, burnt and broken off, 22" dia., S.26°E., 180 lks. No other evidence.
 A Ponderosa Pine windfall 17" dia., fallen on its face, N.50°W., 97 lks. A K-tag & cruiser mark on it. No other evidence.
 Corner falls in a clearcut and burned area.

PHOTO IDENTIFICATION DATA

Photo No. _____
 Filed At. _____
 Object Ident. _____
 Ident. By _____
Signature

DESCRIBE CORNER LOCATION RELATIVE TO NEAR-BY FEATURES, ALSO HOW TO REACH CORNER

PLANE COORDINATE POSITION DATA

State _____ Zone _____
 X _____
 Y _____
 Estab. By _____
Agency

Signature William B. Ham Title PLS Division CS Headquarters SO Date 7/91
 FS-7100-52 (3/68)

CORNER RECORD (PERPETUATION)

MONUMENT: DESCRIBE NEW MONUMENT SET, OR WORK DONE TO PRESERVE EXISTING MONUMENT

Set a 2 1/2" dia. x 30" long steel pipe surmounted by a 2 1/2" dia. brass cap rising 6" in a mound of stone.
A penny at base of pipe. Orig. stone buried along S. side. A steel fence post 3 ft. North.

A rock outcrop 3.5x2.5x1.5', N.02° E., 95.0 ft., mkd. X 80.
Orig SE BT snag, S.26° E., 118.7 ft., Not re-mkd.,
A Ponderosa Pine, 10" dia., S.86° W., 176.7 ft., mkd. X BT.
A Ponderosa Pine, 16" dia., N.32° W., 133.6 ft., mkd. 1/4 S7 BT.

Note: Distances measured to side center of the root crown. A brass washer mkd. LS 2396 nailed to the blaze between the B & T of the scribing.

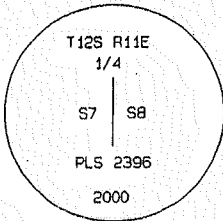

ACC

Differentially corrected. Mapping grade GPS.
ORE SPC, NAD 27, North Zone
N= 321676
E=1751883

DONE TO PRESERVE EXISTING EVIDENCE

Work Done By Bill Ham Title PLS Date 7/91 State Registration No. 2396
or Agency

Certified Cor. Record Prepared? Yes No Filed At: Jeff. Co. Date 7/19/01

REMARKS

GLD Survey of 1883 by Samuel Lacklund, under contract # 476.
Record - @ 40.00 chs. Set Basalt stone 16x14x12 ins. 10 ins. in ground for 1/4 Sec. cor.
marked 1/4 on W. face, from which,
A Y. Pine 24 in. diam. bears S. 23° E. 183 lks. dist. marked 1/4 S B.T.
A Y. Pine 8 in. diam. bears N. 50° W. 97 lks. dist. marked 1/4 S B.T.

Index File No. 0557 T. R. M. Tract or Surv. No. Cor. G-05

USDA-FOREST SERVICE

Index File No. 600 0657 CORNER RECORD (SEARCH) (Ref. FSM 7151.4) Tract or Survey No. 1-1 Cor. No. G-06
 T 12 S. R. 11 E. R.D. Sisters County Jefferson CW 1/16 S.8
 Merid. WM N.F. Deschutes State Oregon

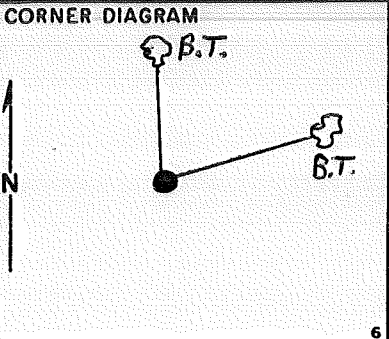

DESCRIBE CORNER MONUMENT FOUND

None Found, Not previously monumented.

DESCRIBE BEARING TREES OR OTHER OFFICIAL ACCESSORIES FOUND

None Found, Not previously monumented.

PHOTO IDENTIFICATION DATA

Photo No. _____
 Filed At. _____
 Object Ident. _____
 Ident. By _____
 Signature _____

DESCRIBE CORNER LOCATION RELATIVE TO NEAR-BY FEATURES, ALSO HOW TO REACH CORNER

Go Westerly along Forest Road #900 approximately 1/2 of mile from intersection with Forest Road #960. Corner lies 270'± North of road.

PLANE COORDINATE POSITION DATA

State _____ Zone _____
 X _____
 Y _____
 Estab. By _____
 Agency _____

Signature David S. Clumathong Title LS 1026 Division _____ Headquarters _____ Date 11/28/2001 FS-7100-52 (3/68)

CORNER RECORD (PERPETUATION)

MONUMENT: DESCRIBE NEW MONUMENT SET, OR WORK DONE TO PRESERVE EXISTING MONUMENT

Set 2-1/2" O.D. X 30" long galvanized iron pipe with 3-1/4" O.D. Brass cap.
 Pipe is 12" in the ground
 Raised 3 foot diameter stone mound to cap.
 Set a steel post 3 feet South of cap.

T12SR11E
 C-W'16C
 58
 CAP MARKED: LS1026
 2001

9

ACCESSORIES: DESCRIBE NEW BT'S WITNESS OBJECTS ETC. ESTABLISHED, OR WORK DONE TO PRESERVE EXISTING EVIDENCE

12" Juniper, N02-1/2°W, 137.5 FT., scribed "CW'165BBT"
 15" Juniper, N57-1/2°E, 222.0 FT., scribed "XBT"
 Painted faces red and red band 6 feet above ground. Nailed brass washer stamped "LS1026" to faces. Attached 54-3" Bearing Tree" signs. Attached flasher sign to back of trees.

10

Work Done By David B. Armstrong Title Land Surveyor Date 10/23/01 State Registration No. LS 1026
 or Agency _____

Certified Cor. Record Prepared? Yes No Filed At: _____ Date _____

11

REMARKS

CONTRACT NO. 50-04GG-1-039

12

Index File No. G-6 T. 12S. R. 11E. M. W.M. Tract or Surv. No. 1-1 Cor. G-6

13

Index File No. 0757

CORNER RECORD (SEARCH)
(Ref. FSM 7151.4)

Tract or Survey No. 1-1

Cor. No. G-07

T 12S R. 11E

R.D. Sisters County Jefferson

Merid. WM

N.F. Deschutes State Oregon C/4 S.8

CORNER DIAGRAM

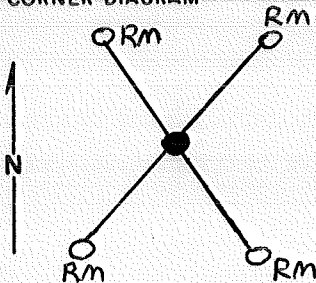

DESCRIBE CORNER MONUMENT FOUND

None Found, Not previously Monumented.

DESCRIBE BEARING TREES OR OTHER OFFICIAL ACCESSORIES FOUND

None Found, Not previously monumented

PHOTO IDENTIFICATION DATA

Photo No. _____
Filed At. _____
Object Ident. _____
Ident. By _____
Signature

DESCRIBE CORNER LOCATION RELATIVE TO NEAR-BY FEATURES, ALSO HOW TO REACH CORNER

Go westerly along Forest Road #900 approximately 1/4 of a mile from intersection with Forest Road #960. Corner lies just North of the road.

PLANE COORDINATE POSITION DATA

State _____ Zone _____
X _____
Y _____
Estab. By _____
Agency

David B. Armstrong Signature Title LS1026 Division

Headquarters

Date 11/28/2001

CORNER RECORD (PERPETUATION)

MONUMENT: DESCRIBE NEW MONUMENT SET, OR WORK DONE TO PRESERVE EXISTING MONUMENT

Set 2-1/2" O.D. x 30" long galvanized iron pipe with 3-1/4" O.D. Brass cap.

Pipe is set 23" in the ground.

Raised 2 foot diameter stone mound to cap.

Set a steel post 3 feet North of cap.

CAP

MARKED:

T12SR11E

C 1/4 58

LS 1026

2001

ACCESSORIES: DESCRIBE NEW BT'S WITNESS OBJECTS ETC. ESTABLISHED, OR WORK DONE TO PRESERVE EXISTING EVIDENCE

Set 1"x24" long smooth iron rod, N36°E, 27.35 FT, stamped "RM1 LS1026 2001"

Set 1"x24" long smooth iron rod, S45-1/2°E, 24.58 FT, stamped "RM2 LS1026 2001"

Set 1"x24" long smooth iron rod, S40°W, 24.59 FT, stamped "RM3 LS1026 2001"

Set 1"x24" long smooth iron rod, N46°W, 27.59 FT, stamped "RM4 LS1026 2001"

Set stones 1 Foot beyond RM's in line with cap. RM's up 3" above surface.

10

Work Done By David B. Armstrong Title Land Surveyor

Date 10/23/01

State Registration No. LS 1026
or Agency

Certified Cor. Record Prepared? Yes No Filed At:

Date

11

REMARKS

CONTRACT NO. 50-04GG-1-039

12

Index File No. G-7

T. 125 R. 11E

M. W.M.

Tract or Surv. No. 1-1

Cor. G-7

13

USDA-FOREST SERVICE

Index File No. G-8 0857

CORNER RECORD (SEARCH)
(Ref. FSM 7151.4)

Tract or Survey No. 1-1

Cor. No. G-08

T 12S. R. 11E.

R.D. Sisters County Jefferson

C-E 1/6 S.8

Merid. W.M.

N.F. Deschutes State Oregon

CORNER DIAGRAM

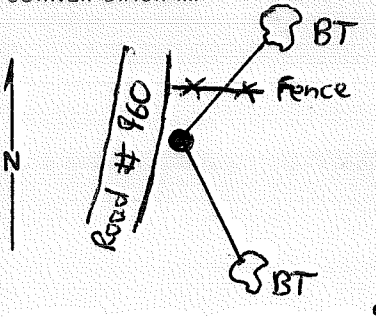

DESCRIBE CORNER MONUMENT FOUND

None found, not previously monumented.

2

DESCRIBE BEARING TREES OR OTHER OFFICIAL ACCESSORIES FOUND

None found, not previously monumented.

6

PHOTO IDENTIFICATION DATA

Photo No. _____

Filed At. _____

Object Ident. _____

Ident. By _____

Signature

7

DESCRIBE CORNER LOCATION RELATIVE TO NEAR-BY FEATURES, ALSO HOW TO REACH CORNER

Go southerly along Forest Road # 960 from the intersection of Forest Road # 900 approximately 1000'±. The corner lies just off the East side of the Road.

3

PLANE COORDINATE POSITION DATA

State _____ Zone _____

X _____

Y _____

Estab. By _____

Agency

8

Signature David B. Armstrong

Title LS1026

Division

Headquarters

Date

11/28/01

FS-7100-52 (3/68)

4

5

CORNER RECORD (PERPETUATION)

MONUMENT: DESCRIBE NEW MONUMENT SET, OR WORK DONE TO PRESERVE EXISTING MONUMENT

Set 2-1/2" O.D. X 30" long galvanized iron pipe with 3-1/4" O.D. Brass cap.
 Pipe is 22" in the ground.
 Raised a 2-1/2 foot diameter stone mound to cap.
 Set a steel post 3 feet North of cap.

T125 R11E

C E 1/16 C

SB

LS 1026

2001

CAP
 MARKED:

ACCESSORIES: DESCRIBE NEW BT'S WITNESS OBJECTS ETC. ESTABLISHED, OR WORK DONE TO PRESERVE EXISTING EVIDENCE

A 10" Ponderosa Pine, N 38-1/2° E, 12.3 ft., scribed "XBT";
 A 18" Ponderosa Pine, S 10-1/2° W, 7.6 ft., scribed "CE 1/16 SB BT".
 A E-W wire fence runs 4 feet North of cap.
 Painted faces red and a red band 6 feet above ground. Nailed brass washer stamped "LS1026" to faces. Attached 54-3 "Bearing Tree" signs.
 Attached flasher sign to back of trees.

10

Work Done By David B. Armstrong Title Land Surveyor Date 10/24/01 State Registration No. LS 1026
 or Agency

Certified Cor. Record Prepared? Yes No Filed At: _____ Date _____ 11

REMARKS

CONTRACT NO. 50-04GG-1-039

12

Index File No. 6-8 T. 125. R. 11E. M. W.M. Tract or Surv. No. 1-1 Cor. _____ 13

USDA-FOREST SERVICE

Index File No. ~~0957~~ **0957**

CORNER RECORD (SEARCH)

(Ref. FSM 7151.4)

Tract or Survey No. 1-1

Cor. No. G-09

T 12S. R. 11 E.

R.D. Sisters

County Jefferson

W 1/4 S. 9

Merid. W.M.

N.F. Deschutes

State Oregon

CORNER DIAGRAM

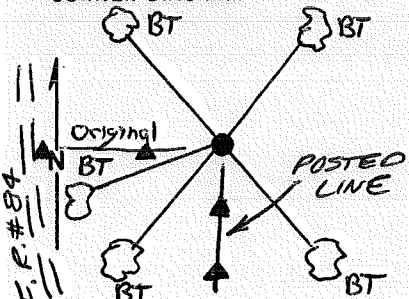

DESCRIBE CORNER MONUMENT FOUND

Found $5/8$ " Iron rod 24 inches long 6" above ground alongside basalt stone 20"x18"x12" firmly set with faint "1/4" marked on down East face. Rod was driven alongside stone. Held stone as corner location.

DESCRIBE BEARING TREES OR OTHER OFFICIAL ACCESSORIES FOUND

Found a 14" diameter Buckskin Ponderosa Pine sawed stump 5 feet high with visible scribing "1/4 SBT" on old chopped out partially charred face. Face oriented $N 10^{\circ} E$, facing at right angle to line from corner. Tree bears $S 78^{\circ} W$, 37.8 ft. to center of original stone.

PHOTO IDENTIFICATION DATA

Photo No. _____
 Filed At. _____
 Object Ident. _____
 Ident. By _____
 Signature _____

PLANE COORDINATE POSITION DATA

State _____ Zone _____
 X _____
 Y _____
 Estab. By _____
 Agency _____

DESCRIBE CORNER LOCATION RELATIVE TO NEAR-BY FEATURES, ALSO HOW TO REACH CORNER

Go Northerly along Forest Road #84 approximately $1/2$ of a mile from where it starts down the grade by Fly Lake. Corner falls just East of the Road on top of a tall cut bank.

Signature David B. Armstrong Title _____

Division L51026

Headquarters _____

Date 11/28/2001

FS-7100-52 (3/68)

CORNER RECORD (PERPETUATION)

MONUMENT: DESCRIBE NEW MONUMENT SET, OR WORK DONE TO PRESERVE EXISTING MONUMENT

Set a 2-1/2" O.D. X 30" Long galvanized iron pipe with 3-1/4" O.D. Brass cap.
 Pipe is 24" in the ground.

T125 R11E

Raised a 3 foot diameter stone mound to cap.
 Deposited original stone North and adjacent to cap.
 Set steel posts 5 ft. West and 3 ft. South.

CAP
 MARKED: 1/4
 SB159
 LS1026
 2001

ACCESSORIES: DESCRIBE NEW BT'S WITNESS OBJECTS ETC. ESTABLISHED, OR WORK DONE TO PRESERVE EXISTING EVIDENCE

- 9" Ponderosa Pine, N40-1/2°E, 23.2 ft., scribed "XBT";
- 7" Juniper, S50°E, 12.5 ft., scribed "1/4 SB BT";
- 14" Ponderosa Pine, S19°W, 20.4 ft., scribed "X 1/4 SB BT";
- 12" Ponderosa Pine, N72°W, 22.2 ft., scribed "1/4 SB BT".

Painted faces red and a red band 6 feet above ground. Nailed brass washer stamped "LS1026" to faces. Attached 54-3 "Bearing Tree" sign. Attached flasher sign to back of trees.

Work Done By David B. Armstrong Title Land Surveyor Date 10/22/01 State Registration No. LS1026
 or Agency _____

Certified Cor. Record Prepared? Yes No Filed At: _____ Date _____

REMARKS

CONTRACT NO. 50-0466-1-039

Index File No. G-9 T. 125 R. 11E M. W.M. Tract or Surv. No. 1-1 Cor. 13

USDA-FOREST SERVICE

Index File No. 140 0558

CORNER RECORD (SEARCH)
(Ref. FSM 7151.4)

Tract or Survey No. 1-1

Cor. No. H-05

T. 12S. R. 11E.

R.D. Sisters

County Jefferson

S/16 7/8

Merid. W.M.

N.F. Deschutes

State Oregon

CORNER DIAGRAM

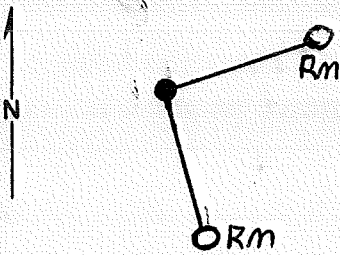

DESCRIBE CORNER MONUMENT FOUND

None found, not previously monumented.

DESCRIBE BEARING TREES OR OTHER OFFICIAL ACCESSORIES FOUND

None found, not previously monumented.

PHOTO IDENTIFICATION DATA

Photo No. _____

Filed At. _____

Object Ident. _____

Ident. By _____

Signature

PLANE COORDINATE POSITION DATA

State _____ Zone _____

X _____

Y _____

Estab. By _____

Agency

DESCRIBE CORNER LOCATION RELATIVE TO NEAR-BY FEATURES, ALSO HOW TO REACH CORNER

Go westerly along Forest Road #900 approximately 3/4 of a mile from intersection with Forest Road #960. Corner lies 100± South of Road.

David B. Armstrong

Signature

LS1026

Title

Division

Headquarters

Date

11/28/2001

FS-7100-52 (3/68)

CORNER RECORD (PERPETUATION)

MONUMENT: DESCRIBE NEW MONUMENT SET, OR WORK DONE TO PRESERVE EXISTING MONUMENT

Set 2-1/2" O.D. X 30" long galvanized iron pipe with 2-1/2" O.D. Brass cap.
 Pipe is 27" in the ground. T12S R11E
 Raised a 2 foot diameter stone mound to cap. 5'16
 Set a steel post 3 feet North of cap. 57158
 CAP MARKED: LS1026
 2001

ACCESSORIES: DESCRIBE NEW BT'S WITNESS OBJECTS ETC. ESTABLISHED, OR WORK DONE TO PRESERVE EXISTING EVIDENCE

1" X 24" long smooth iron rod, N68-1/2° E, 15.61 ft., stamped "RM1 LS1026 2001"
 1" X 24" long smooth iron rod, S16° E, 18.33 ft., stamped "RM2 LS1026 2001"
 Set stones 1 foot beyond RM's in line with cap.
 RM's up 3" above ground surface.

Work Done By David B. Armstrong Title Land Surveyor Date 10/24/01 State Registration No. LS1026
 or Agency

Certified Cor. Record Prepared? Yes No Filed At: _____ Date _____

REMARKS

CONTRACT NO. 50-04GG-1-039

Index File No. H-5 T. 12S. R. 11E. M. W.M. Tract or Surv. No. 1-1 Cor. _____

Index File No. ~~116~~ 0658

CORNER RECORD (SEARCH)
(Ref. FSM 7151.4)

Tract or Survey No. 1-1

Cor. No. H-06

T. 12S. R. 11E.

R.D. Sisters

County Jefferson

SW 1/4 S. 8

Merid. W.M.

N.F. Deschutes

State Oregon

CORNER DIAGRAM

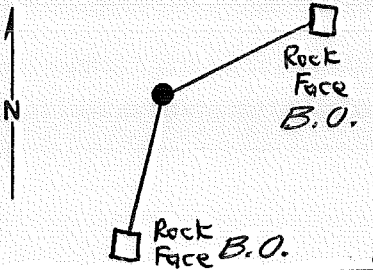

DESCRIBE CORNER MONUMENT FOUND

None found, not previously monumented.

DESCRIBE BEARING TREES OR OTHER OFFICIAL ACCESSORIES FOUND

None found, not previously monumented.

PHOTO IDENTIFICATION DATA

Photo No. _____
 Filed At. _____
 Object Ident. _____
 Ident. By _____
 Signature _____

DESCRIBE CORNER LOCATION RELATIVE TO NEAR-BY FEATURES, ALSO HOW TO REACH CORNER

Go westerly along Forest Road #900 approximately 1/2 of a mile from intersection with Forest Road #960. Corner lies 1050' ± South of Road at the very top of a steep hill.

PLANE COORDINATE POSITION DATA

State _____ Zone _____
 X _____
 Y _____
 Estab. By _____
 Agency _____

Signature: David B. Armstrong Title: LS1026 Division: _____ Headquarters: _____

Date: 11/28/01 FS-7100-52 (3/68)

CORNER RECORD (PERPETUATION)

MONUMENT: DESCRIBE NEW MONUMENT SET, OR WORK DONE TO PRESERVE EXISTING MONUMENT

Set a 2-1/2" O.D. Brass disk in drill hole in rock ledge.
Set a steel post 4 feet North of cap.

T12S R11E

SW 1/16 58

LS1026

CAP

MARKED:

2001

ACCESSORIES: DESCRIBE NEW BT'S WITNESS OBJECTS ETC. ESTABLISHED, OR WORK DONE TO PRESERVE EXISTING EVIDENCE

A rock face, N66°E, 5.05 ft., marked "B0 X";

A rock face, S09-1/2°W, 5.25 ft., marked "B01 X".

Distances and bearing are measured to the center of the "X"

10

Work Done By David B. Armstrong Title Land Surveyor Date 10/24/01 State Registration No. LS1026
or Agency

Certified Cor. Record Prepared? Yes No Filed At:

Date

11

REMARKS

CONTRACT NO. 50-0499-1-039

12

Index File No. H-6 T. 12 S. R. 11 E. M. W.M. Tract or Surv. No. 1-1

Cor.

13

USDA-FOREST SERVICE

Index File No. H-8 0858

CORNER RECORD (SEARCH)
(Ref. FSM 7151.4)

Tract or Survey No. 1-1

Cor. No. H-08

T 12 S. R. 11 E.

R.D. Sisters County Jefferson

SE 1/16 S. 8

Merid. W.M.

N.F. Deschutes State Oregon

CORNER DIAGRAM

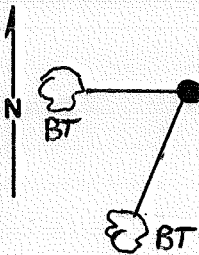

DESCRIBE CORNER MONUMENT FOUND

None found, not previously monumented.

DESCRIBE BEARING TREES OR OTHER OFFICIAL ACCESSORIES FOUND

None found, not previously monumented.

PHOTO IDENTIFICATION DATA

Photo No. _____
 Filed At. _____
 Object Ident. _____
 Ident. By _____
 Signature _____

DESCRIBE CORNER LOCATION RELATIVE TO NEAR-BY FEATURES, ALSO HOW TO REACH CORNER

Go southerly along Forest Road #960 from the intersection of Forest Road #900 approximately 2350'±. The corner lies 450'± East of the Road.

PLANE COORDINATE POSITION DATA

State _____ Zone _____
 X _____
 Y _____
 Estab. By _____
 Agency _____

Signature David D. Armstrong Title _____ Division LS1026

Headquarters _____ Date 11/28/01

FS-7100-52 (3/68)

CORNER RECORD (PERPETUATION)

MONUMENT: DESCRIBE NEW MONUMENT SET, OR WORK DONE TO PRESERVE EXISTING MONUMENT

Set 2-1/2" O.D. X 30" Long galvanized iron pipe with 2-1/2" O.D. brass cap.
Pipe is 15" in the ground.

Raised a 3 feet diameter stone mound to cap.

CAP T125 R11E
MARKED: SE 1/16 SB
LS1026
2001

9

ACCESSORIES: DESCRIBE NEW BT'S WITNESS OBJECTS ETC. ESTABLISHED, OR WORK DONE TO PRESERVE EXISTING EVIDENCE

A 9" Ponderosa Pine, S 20° W, 43.4 ft., scribed "XBT";

A 7" Juniper, West, 36.9 ft., scribed "SE 1/16 SBBT".

Painted faces red and a red band 6 feet above ground. Nailed brass washer stamped "LS1026" to faces. Attached 54-3 "Bearing Tree" signs. Attached flasher sign to back of trees.

10

Work Done By David B. Armstrong Title Land Surveyor Date 10/31/01 State Registration No. LS1026
or Agency

Certified Cor. Record Prepared? Yes No Filed At: _____ Date _____

11

REMARKS

CONTRACT NO. 50-0466-1-039

12

Index File No. H-8 T. 12 S. R. 11 E. M. W. M. Tract or Surv. No. 1-1 Cor. _____

13

Index File No. ~~0958~~ **0958**

CORNER RECORD (SEARCH)

(Ref. FSM 7151.4)

Tract or Survey No. 1-1

Cor. No. H-09

T 12S. R. 11E.

R.D. Sisters

County Jefferson

S/16

8/9

Merid. W.M.

N.F. Deschutes

State Oregon

CORNER DIAGRAM

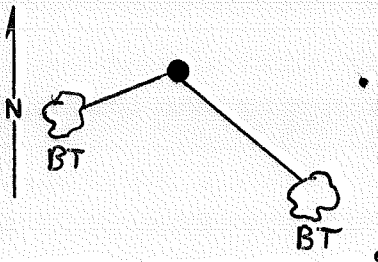

DESCRIBE CORNER MONUMENT FOUND

None found, not previously monumented.

2

DESCRIBE BEARING TREES OR OTHER OFFICIAL ACCESSORIES FOUND

None found, not previously monumented.

6

PHOTO IDENTIFICATION DATA

Photo No. _____
 Filed At. _____
 Object Ident. _____
 Ident. By _____
 Signature _____

7

PLANE COORDINATE POSITION DATA

State _____ Zone _____
 X _____
 Y _____
 Estab. By _____
 Agency _____

8

DESCRIBE CORNER LOCATION RELATIVE TO NEAR-BY FEATURES, ALSO HOW TO REACH CORNER

Take the Road off of Forest Road #84 to Fly Lake.
 The corner lies approximately 250' from the
 Northerly high water mark of the Lake.

3

4

Signature David P. Armstrong Title LS1026 Division _____

Headquarters _____

Date _____

11/28/2001

FS-7100-52 (3/68)

5

CORNER RECORD (PERPETUATION)

MONUMENT: DESCRIBE NEW MONUMENT SET, OR WORK DONE TO PRESERVE EXISTING MONUMENT

Set 2-1/2" O.D. x 30" long galvanized iron pipe with 2-1/2" O.D. Brass cap.
 Pipe is 15" in the ground.

Raised 3 foot diameter stone mound to cap.

Set a steel post 3 feet North of cap.

T12S R11E
 CAP 5'16
 MARKED: 58159
 LS1026
 2001

ACCESSORIES: DESCRIBE NEW BT'S WITNESS OBJECTS ETC. ESTABLISHED, OR WORK DONE TO PRESERVE EXISTING EVIDENCE

6" Juniper, S 42-1/2° E, 39.1 ft., scribed "XBT";

5" x 7" x 5" x 5" Juniper, S 82-1/2° W, 23.3 ft., scribed "S 1/16 SE BT".

Painted faces red and a red band 6 feet above ground. Nailed brass washer stamped "LS1026" to faces. Attached 54-3 "Bearing Tree" signs. Attached flasher sign to back of trees.

Work Done By David B. Armstrong Title Land Surveyor Date 10/31/01 State Registration No. LS1026
 or Agency

Certified Cor. Record Prepared? Yes No Filed At: _____ Date _____

REMARKS

CONTRACT NO. 50-04GG-1-039

Index File No. H-9 T. 12S. R. 11E. M. W.M. Tract or Surv. No. 1-1 Cor. 13

Index
File No. 0159 CORNER RECORD (SEARCH) Contract or
(Ref. FSM 7151.4) Survey No. _____ Cor. No. J-01
T 12 S. R. 11 E. R.D. SISTERS County Jefferson NW Cor. of
Merid. WILLAMETTE N.F. DESCHUTES State OREGON Section 18

SEE: J-25 T. 12 S., R. 10 E., W.M.

SFNF

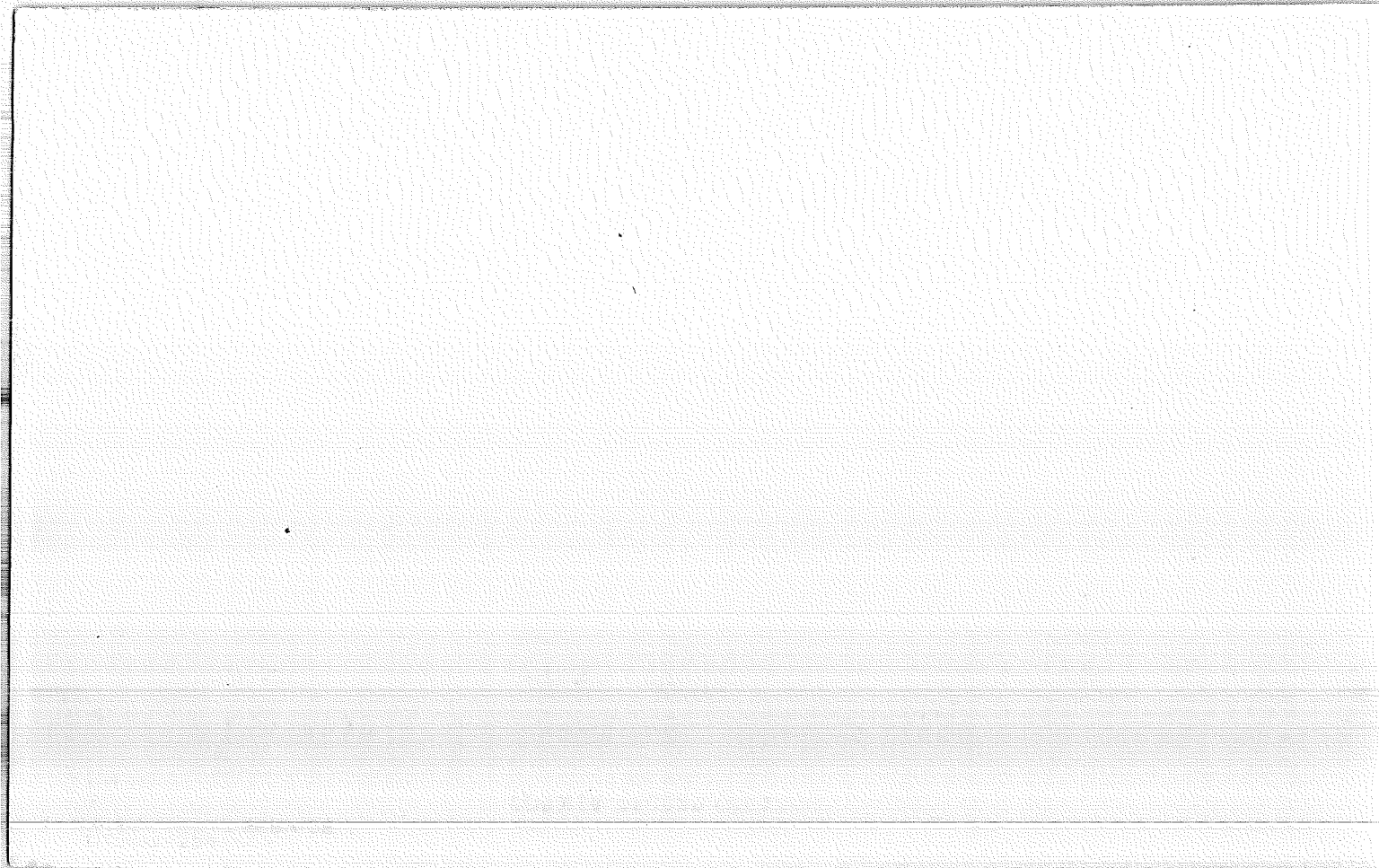

Index
File No. 0559

CORNER RECORD (SEARCH)

(Ref. FSM 7151.4)

Tract or
Survey No. _____

Cor.
No. J-05

T 12 S. R. 11 E.

R.D. SISTERS County JEFFERSON

Merid. WMT

N.F. DESCHUTES State OR

NW/cor S.17

CORNER DIAGRAM

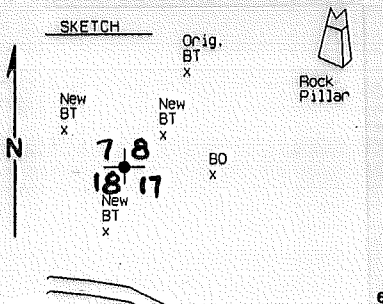

DESCRIBE CORNER MONUMENT FOUND

Found - Original slate stone 20x10x5 ins. mkd. with 4 grooves on the South and 5 grooves on East faces, lying in a mound of stones.

2

DESCRIBE BEARING TREES OR OTHER OFFICIAL ACCESSORIES FOUND

A stumphole at NW BT location.
No evidence of Orig. SW BT.
No evidence of Orig. SE BT.
A Ponderosa Pine windfall, N.37°E., 160 lks., with face and scribing exposed.

3

DESCRIBE CORNER LOCATION RELATIVE TO NEAR-BY FEATURES, ALSO HOW TO REACH CORNER

PHOTO IDENTIFICATION
Photo No. _____
Filed At _____
Object Ident. _____
Ident. By _____
Signature _____

7

PLANE COORDINATE POSITION DATA

State _____ Zone _____
X _____
Y _____
Estab. By _____
Agency _____

8

Signature
William B. Ham

Title
PLS

Division
CS

Headquarters
SO

Date
7/91

FS-7100-52 (3/68)

4

5

CORNER RECORD (PERPETUATION)

MONUMENT: DESCRIBE NEW MONUMENT SET, OR WORK DONE TO PRESERVE EXISTING MONUMENT

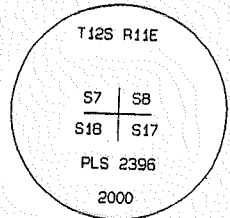

Set a 2 1/2" dia. x 30" long steel pipe surmounted by a 2 1/2" dia. brass cap rising 8" in a mound of stone. A penny at base of pipe. Orig. stone buried along S. side. A steel fence post 4.7 ft. North.

- A Juniper 3" dia., N.40° E., 38.8 ft., mkd. X BT.
- A Rock outcrop 4'x3'x3' high, S.80° E., 31.0 ft., mkd. X B0.
- A Ponderosa Pine 12" dia. S.12° W., 32.9 ft., mkd. T12SR11E S18 BT.
- A Ponderosa Pine 15" dia. N.67° W., 69.6 ft., mkd. T12SR11E S7 BT.

A rock pillar 32'x12'x33' high, shaped like a gunsight, bears N.61° E., 386 ft. to SW corner of pillar.

Trees measured to side center at the root crown. A 1" dia. brass washer mkd. LS 2396 nailed to the blaze between the B & T of the scribing.

Differentially corrected, Mapping Grade GPS,
 ORE SPC, NAD 27 North Zone
 N= 319231
 E=1751840

E EXISTING EVIDENCE

10

Work Done By Bill Ham Title PLS Date 7/91 State Registration No. 2396
 or Agency

Certified Cor. Record Prepared? Yes No Filed At: Jeff. Co. Date 07/19/01

11

REMARKS

GL0 Survey of 1883 by Samuel Lacklund, under Contract # 476.
 Record - Set Sandstone 18x10x10 ins. 12 ins. in ground for cor. to Secs. 7, 8, 17 and 18, marked with 4 notches on S. and 5 notches on E. edges, from which,
 A y. Pine 8 in. diam. bears N. 74° W. 56 lks. dist. marked T12S.R11E. S7 B.T.
 A y. Pine 12 in. diam. bears S. 37° W. 152 lks. dist. marked T12S.R11E. S18 B.T.
 A y. Pine 8 in. diam. bears S. 19° E. 130 lks. dist. marked T12S.R11E. S17 B.T.
 A y. Pine 10 in. diam. bears N. 36° E. 159 lks. dist. marked T12SR11E S8 B.T.

12

Index File No. 0559 T. R. M. Tract or Surv. No. Cor. J-05

13

Index
File No. 0759

CORNER RECORD (SEARCH)

(Ref. FSM 7151.4)

Tract or Survey No. _____
Cor. No. J-07

T 12 S R. 11 E R.D. Sisters County Jefferson N/A sec. 17
Merid. Wmt N.F. Deschutes State Oregon

CORNER DIAGRAM

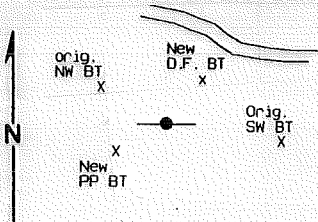

DESCRIBE CORNER MONUMENT FOUND

Found Original stone 15"x10"x8" clearly marked 1/4 on North face, set firmly in the ground.
A Ponderosa Pine 30" dia. N.10 W. 36 lks. with face and scribing visible.
A Ponderosa Pine snag, 28" dia. S.84 E., 55 lks. with face and scribing visible.
Note: Distances measured to face. 2

DESC A location poster on old spur road, 260 ft. North.

PHOTO IDENTIFICATION DATA

Photo No. _____
Filed At. _____
Object Ident. _____
Ident. By _____
Signature 7

DESCRIBE CORNER LOCATION RELATIVE TO NEAR-BY FEATURES, ALSO HOW TO REACH CORNER

PLANE COORDINATE POSITION DATA

State _____ Zone _____
X _____
Y _____
Estab. By _____
Agency 8

Signature Bill Ham Title PLS Division CS Headquarters SO Date 11/00 FS-7100-52 (3/68) 5

CORNER RECORD (PERPETUATION)

MONUMENT: DESCRIBE NEW MONUMENT SET, OR WORK DONE TO PRESERVE EXISTING MONUMENT

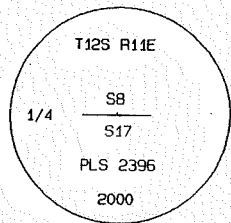

Set a 2 1/2" dia. x 30" long steel pipe surmounted by a 2 1/2" dia. brass cap rising 4" in a mound of stone. A "DEEP 1" magnet and a penny at base of pipe. Orig. stone buried along side. A steel fence post 3 ft. North.

- A Douglas Fir, 24" dia., N.16 E., 33.4 ft., mkd. 1/4 S8 BT.
- A Ponderosa Pine snag, 28" dia., S.84 E., 36.6 ft., Original BT, Not re-marked.
- A Ponderosa Pine, 14" dia., S.29 W., 28.8 ft., mkd. 1/4 S17 BT.
- A Ponderosa Pine, 30" dia., N.10 W., 24.4 ft., original BT, Not re-marked.

RVE

Note: Distances measured to side center of the root crown. A brass washer mkd. LS 2396 nailed to the blaze between the B & T of the scribing.

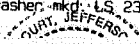

10

Work Done By Bill Hamer Title PLS Date 11/6/00 State Registration No. 2396
or Agency

Certified Cor. Record Prepared? Yes No Filed At J&J Co. Date 11/14/00

11

REMARKS

GLD Survey of 1893 by Samuel Lacklund.
Record - 0 39.80 chs. Set Basalt stone 15x10x9 ins. 10 ins. in ground for 1/4 Sec. cor.
marked 1/4 on N. face, from which
A Y. Pine 20 in. diam. bears N. 10° W. 36 lks. dist. marked 1/4 S B.T.
A Y. Pine 20 in. diam. bears S. 84° E. 55 lks. dist. marked 1/4 S B.T.

Index File No. 0759 T. R. M. Tract or Surv. No. Cor. J-07

12

13

USDA-FOREST SERVICE

Index File No. 1100 0859

CORNER RECORD (SEARCH)
(Ref. FSM 7151.4)

Tract or Survey No. 1-1

Cor. No. J-08

T 12S. R. 11E.

R.D. Sisters County Jefferson

E 1/6 8/17

Merid. W.M.

N.F. Deschutes State Oregon

CORNER DIAGRAM

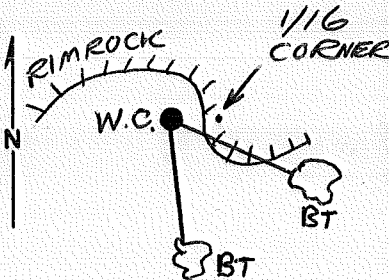

DESCRIBE CORNER MONUMENT FOUND

None found, not previously monumented.

DESCRIBE BEARING TREES OR OTHER OFFICIAL ACCESSORIES FOUND

None found, not previously monumented.

PHOTO IDENTIFICATION DATA

Photo No. _____
 Filed At. _____
 Object Ident. _____
 Ident. By _____
 Signature _____

DESCRIBE CORNER LOCATION RELATIVE TO NEAR-BY FEATURES, ALSO HOW TO REACH CORNER

Corner lies 1100' ± West of Forest Road #84 where it starts down the grade by Fly Lake.
 WITNESS
 A Corner falls on top of Rimrock, TRUE CORNER IS BELOW RIM.

PLANE COORDINATE POSITION DATA

State _____ Zone _____
 X _____
 Y _____
 Estab. By _____
 Agency _____

Signature David S. Clemens Title LS 1026 Division 1 Headquarters 11/28/2001 Date FS-7100-52 (3/68)

CORNER RECORD (PERPETUATION)

MONUMENT: DESCRIBE NEW MONUMENT SET, OR WORK DONE TO PRESERVE EXISTING MONUMENT

Set 2-1/2" O.D. Brass Disk in drill hole on top of rimrock. as a witness corner.
 Set a steel post 2-1/2 feet North of cap.
 True corner position lies N88°48'38"E, 7.19 ft. from cap.

CAP MARKED: WC
 T125 R11E
 E 1/16 S17
 LS1026 N88°48'38"E
 2001 → 7.19'

ACCESSORIES: DESCRIBE NEW BT'S WITNESS OBJECTS ETC. ESTABLISHED, OR WORK DONE TO PRESERVE EXISTING EVIDENCE

12" Juniper, S 55-1/2° E, 13.9 ft., scribed "E 1/16 S17 BT"
 5" Juniper, S 07-1/2° W, 69.2 ft., scribed "X BT"
 Painted faces red and a red band 6 feet above ground. Nailed brass washer stamped "LS1026" to faces. Attached S4-3 "Bearing Tree" sign.
 Attached flusher sign to back of trees.

10

Work Done By David B. Armstrong Title Land Surveyor Date 10/31/01 State Registration No. or Agency LS1026

Certified Cor. Record Prepared? Yes No Filed At: _____ Date _____

11

REMARKS

CONTRACT NO. 50-04GG-1-039

12

Index File No. J-8 T. 125 R. 11E M. W.M. Tract or Surv. No. 1-1 Cor. _____

13

Index
File No. 0959

CORNER RECORD (SEARCH)

(Ref. FSM 7151.4)

Tract or
Survey No. _____ Cor.
No. J-09

T 12 S R. 11 E

R.D. Sisters County Jefferson

Merid. WMT

N.F. Douglas State Oregon

NW Cor Sec. 16

CORNER DIAGRAM

DESCRIBE CORNER MONUMENT FOUND

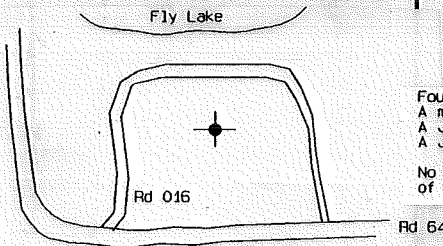

Found - Original Basalt stone 17x15x8 ins. mkd. with 4 grooves on South and East faces.
A mound of stones surrounded the corner stone.
A Juniper 20" dia. bears N. 17° W. 60 lks. dist. with face and scribing visible.
A Juniper snag 6 in. dia. bears S. 67° E. 100 lks. dist. with face and scribing visible.

No evidence of the NE or SE BT's. NOTE: To reach the corner, take Rd.#016 off County road 64 at the curve at the top of the hill. The corner is south of the Fly Lake parking area. No location poster was put up.

PHOTO IDENTIFICATION DATA

Photo No. _____
Filed At. _____
Object Ident. _____
Ident. By _____
Signature

DESCRIBE CORNER LOCATION RELATIVE TO NEAR-BY FEATURES, ALSO HOW TO REACH CORNER

PLANE COORDINATE POSITION DATA

State _____ Zone _____
X _____
Y _____
Estab. By _____
Agency

Signature
Bill Ham

Title
PLS

Division
CS

Headquarters
SO

Date
11/6/2000

CORNER RECORD (PERPETUATION)

MONUMENT: DESCRIBE NEW MONUMENT SET, OR WORK DONE TO PRESERVE EXISTING MONUMENT

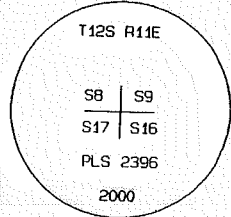

Set a 2 1/2" dia. x 30" long steel pipe surmounted by a 2 1/2" dia. brass cap rising 8" in a mound of stone. A penny at base of pipe. Orig. stone buried along side. A steel fence post 3 1/2 ft. West.
 A Juniper 5" dia., N.32 E., 26.5 ft., mkd. X BT.
 A Ponderosa Pine, 20" dia., S.11 E., 22.7 ft., mkd. T12SR11E S16 BT.
 Used remaining original BT's as SW and NW references.

Trees measured to side center at the root crown. A brass washer mkd. LS 2396 nailed to the blaze between the B & T of the scribing.

Work Done By Bill Ham Title PLS Date 11/6/00 State Registration No. 2396
 or Agency

Certified Cor. Record Prepared? Yes No Filed At: Set Co. Date 11/14/00

REMARKS

GLD Survey of 1883 by Samuel Lacklund.
 Record - Set Basalt stone 20x14x10 ins. 14 ins. in ground for cor. to Secs. 8, 9, 16 and 17, marked with 4 notches on S. and E. edges, from which:
 A Juniper 5 in. diam. bears S. 56°W. 105 lks. dist. marked T12SR11E S17 B.T.
 A Juniper 20 in. diam. bears S. 51°E. 223 lks. dist. marked T12SR11E S16 B.T.
 A Juniper 8 in. diam. bears N. 8°W. 38 lks. dist. marked T12SR11E S 8 B.T.
 A Juniper 10 in. diam. bears N. 58°E. 176 lks. dist. marked T12SR11E S 9 B.T.

Index File No. 0959 T. R. M. Tract or Surv. No. Cor. J-09

USDA-FOREST SERVICE

Index

File No. 0161CORNER RECORD (SEARCH) Contract or

(Ref. FSM 7151.4)

Survey No.

Cor.

No. L-01T 12 S. R. 11 E. R.D.SISTERS

County

JEFFERSONW/4

Cor. of

Merid. WILLAMETTE N.F.DESCHUTES

State

OREGON

Section

18SEE: L-25 T. 12 S., R. 10 E., W.M.

SF/NF



Index

File No. 0162

CORNER RECORD (SEARCH)

(Ref. FSM 7151.4)

Contract or

Survey No.

Cor.

No.

N-01

T 12 S. R. 11 E. R.D.

SISTERS

County

JEFFERSON

SW

Cor. of

Merid. WILLAMETTE

N.F.

DESCHUTES

State

OREGON

Section 18

SEE: N-25 T. 12 S., R. 10 E., W.M.

SF/NF



Index
File No. 0963

CORNER RECORD (SEARCH)
(Ref. FSM 7151.4)

Tract or Survey No. _____
Cor. No. N-09

T 12S R. 11E
Merid. WMT

R.D. Grasslands County Jefferson
N.F. Och State OR

NW Sec. 21

CORNER DIAGRAM

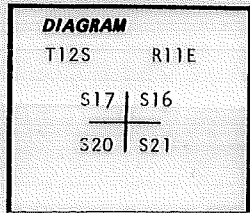

DESCRIBE CORNER MONUMENT FOUND

DES

Found: 20" P.Pine, N52°W, 19 lks, scribing visible, record. Field, N59°W, 14.7'.
26" Pine, dead and down, S43°E, 57 lks
16" Pine, dead and down, S46°W, 99 lks

Found 12"X11"X9" stone with 4 notches on the east and 3 notches on the south edges in mound of stone.

PHOTO IDENTIFICATION DATA

Photo No. _____
Filed At. _____
Object Ident. _____
Ident. By _____
Signature

DESCRIBE CORNER LOCATION RELATIVE TO NEAR-BY FEATURES, ALSO HOW TO REACH CORNER

PLANE COORDINATE POSITION DATA

State _____ Zone _____
X _____
Y _____
Estab. By _____
Agency

Signature
Ed Graves

Title
PLS

Division _____
Headquarters _____

Date
12/8/02

CORNER RECORD (PERPETUATION)

MONUMENT: DESCRIBE NEW MONUMENT SET, OR WORK DONE TO PRESERVE EXISTING MONUMENT

Set 2"X30" Aluminum pipe with 3 1/4" Aluminum cap 24" in ground with mound of stone to top. Buried 12"X11"X9" stone on north side of cap. Set steel post 3' west with 54-4 sign.

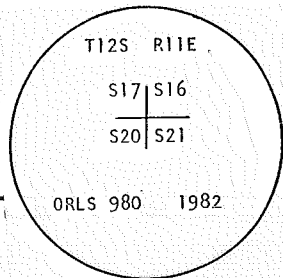

New bearing trees set:

PRESERVE

ACCE

- 5" P.Pine, N55 1/2°E, 26.7', Scribed T12S R11E S16 BT
- 8" P.Pine, S49°E, 86.7', Scribed T12S R11E S21 BT
- 9" Juniper, S42 1/2°W, 110.3', Scribed T12S R11E S20 BT

All bearing trees have red band painted around them. Tagged trees with 54-3 and 54-4 signs and LS 980 Brass Washer.

10

Work Done By Ed Graves Title PLS Date 11/82 State Registration No. 980
 or Agency _____
 Certified Cor. Record Prepared? (Yes) No Filed At: Jett. Date 12/8/82 11

Corner established in 1883 by Samuel W. Lackland, under General Land Office Contract No. 476, dated May 18, 1883.

Set 15X10X9" sand stone for Section corner to Sections 16, 17, 20 and 21. Marked stone with 3 notches on south and 4 notches on east edges, from which:

- a pine, 14" in diam, bears N89°E, 61 lks dist.
- a pine, 7" in diam, bears N52°W, 19 lks dist.
- a pine, 14" in diam, bears S43°E, 57 lks dist.
- a pine, 12" in diam, bears S46°W, 99 lks dist.

Index File No.

0963

125

N.

11E

M.

Tract or Surv. No.

Cor.

N-09

12

13

USDA-FOREST SERVICE

Index File No. 0167

T 12S R. 11E
Merid. WMP

CORNER RECORD (SEARCH)
(Ref. FSM 7151.4)

R.D. Grasslands County Jefferson
N.F. Och State OR

Tract or Survey No. _____
Cor. No. R-01

NW/40-S, 30

CORNER DIAGRAM

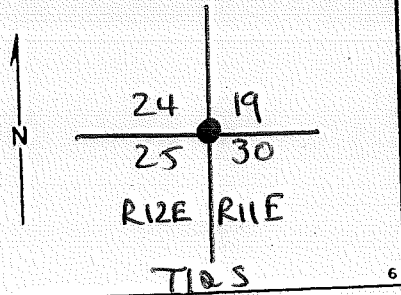

DESCRIBE CORNER MONUMENT FOUND

FROM 1881 SURVEY:
 16" X 14" X 14" TRAP STONE - FOUND. 2
 16" PINE N62°E 72 LINKS - FOUND A STUMP W/VISIBLE SCRIBES.
 26" PINE S38°E 85 LINKS - FOUND A STUMP W/AXE WORK. FOUND
 24" PINE S10°W 74 LINKS - FOUND A STUMP W/VISIBLE SCRIBES.
 14" PINE N40°W 85 LINKS - FOUND A BLOWNDOWN DEAD TREE W/VISIBLE SCRIBES.

PHOTO IDENTIFICATION DATA

Photo No. _____
 Filed At. _____
 Object Ident. _____
 Ident. By _____
Signature

DESCRIBE CORNER LOCATION RELATIVE TO NEAR-BY FEATURES, ALSO HOW TO REACH CORNER

PLANE COORDINATE POSITION DATA

State _____ Zone _____
 X _____
 Y _____
 Estab. By _____
Agency

Signature John A VanCleave Title PLS

Division _____ Headquarters _____

Date 6/2/95 FS-7100-52 (3/68)

CORNER RECORD (PERPETUATION)

MONUMENT: DESCRIBE NEW MONUMENT SET, OR WORK DONE TO PRESERVE EXISTING MONUMENT

1/4" YELLOW PLASTIC

SET A 5/8" X 30" IRON ROD 28" IN THE GROUND W/YELLOW PLASTIC CAP MARKED "WILLAMETTE INDUSTRIES, INC." IN PLACE OF THE STONE. SET THE STONE ALONGSIDE THE ROD AND COVERED WITH A ROCK MOUND.

11" PINE N53°E 32.55 FEET MARKED T12SR11E S19 BT.

14" PINE N08°W 52.74 FEET MARKED T12SR10E S24 BT.

ACCE: 7" PINE S24°E 37.58 FEET MARKED T12SR11E S30 BT.

12" PINE S72°W 68.62 FEET MARKED T12SR10E S25 BT.

DISTANCES TO BEARING TREES ARE MEASURED TO A NAIL AT THE CENTER OF THE TREE WITH A 75' STEEL TAPE. BEARINGS ARE TAKEN WITH A HAND COMPASS. PAINTED THE FACES RED AND PLACED A YELLOW BT TAG ON ALL TREES.

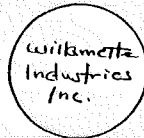

E EXISTING EVIDENCE

Work Done By JA Van Cleave Title PLS Date 6/95 State Registration No. 1923 or Agency

Certified Cor. Record Prepared Yes No Filed At: Jeff. Co. Date 6/26/95

REMARKS

Index File No. T R M Tract or Surv. No. 12

0167 T 12 S 11 E GPO: 1986 O-439-095 Cor. R-01 13

Index
File No. 0767

CORNER RECORD (SEARCH)

(Ref. FSM 7151.4)

Tract or Survey No. _____
Cor. No. R-07

T 12 S R. 11 E

R.D. Grasslands County Jefferson

Merid. Wmt

N.F. Och State OR

5/4 S.20

CORNER DIAGRAM

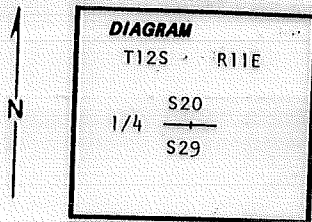

DESCRIBE CORNER MONUMENT FOUND

DES

Found: 16" Pine stob, S72°E, 48 lks, scribed 1/4 S BT
13" Pine, N78°W, 21 lks, scribed 1/4 S BT, Windfall

2

Found 15"X12"X7" stone, no distinguishable markings, in mound of stone.

PHOTO IDENTIFICATION DATA

Photo No. _____
Filed At. _____
Object Ident. _____
Ident. By _____
Signature

6

DESCRIBE CORNER LOCATION RELATIVE TO NEAR-BY FEATURES, ALSO HOW TO REACH CORNER

3

PLANE COORDINATE POSITION DATA

State _____ Zone _____
X _____
Y _____
Estab. By _____
Agent

8

Signature
Ed Graves

Title
PLS

Division

Headquarters

Date 11/17/82 FS-7100-52 (3/68)

4

5

CORNER RECORD (PERPETUATION)

MONUMENT: DESCRIBE NEW MONUMENT SET, OR WORK DONE TO PRESERVE EXISTING MONUMENT

Set 2"X30" Aluminum pipe with 3 1/4" Aluminum cap 24" in ground with mound of stone to top. Buried unmarked 15"X12"X7" stone on north side of cap. Set steel post 3' west of monument with 54-4 sign.

ACC

New bearing trees set:

5" Juniper, N62°E, 58.5', Scribed 1/4 S20 BT
5" P.Pine, South, 25.6', Scribed 1/4 S29 BT

All bearing trees have red band painted around them. Tagged trees with 54-3 and 54-4 signs and LS 980 Brass Washer.

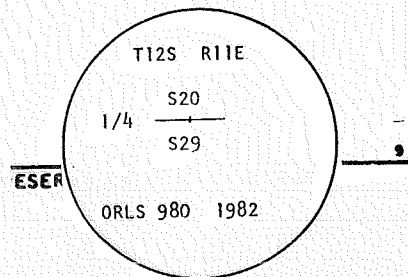

Work Done By Ed Graves Title PLS Date 11/82 State Registration No. 980
or Agency _____
Certified Cor. Record Prepared No Filed At: Jefferson Date 12/8/82

REMARKS

Corner established in 1883 by Samuel W. Lackland, under General Land Office Contract No. 476, dated May 18, 1883.

Set 15X10X8 inch basalt stone for 1/4 corner to Sections 20 and 29. Marked 1/4 on north face of stone, from which:

a pine, 14" in diam, bears S72°E, 48 lks dist.
a pine, 12" in diam, bears N78°W, 21 lks dist.

Index File No. 0767 T. 12 R. 11 M. _____ Tract or Surv. No. _____ Cor. P-07
GPO: 1986 O-439-095

USDA-FOREST SERVICE

Index

File No.

0175

CORNER RECORD (SEARCH)

(Ref. FSM 7151.4)

Contract or

Survey No.

Cor.

No.

Z-01

T 12 S. R. 11 E. R.D.

Sisters

County

Jeff

SW

Cor. of

Merid. WILLAMETTE N.F.

DESCHUTES

State

OREGON

Section

31

SEE:

A-01

T. 13

S., R. 11

E.W.M.

#5 SR w/ plastic cap

